

TWIN WHEEL CASTER (PLATE TYPE)



GX-60-PS, P

- Heavy duty and low profile.
- Twin wheel caster with excellent stability.



GX-60-PS  
(w/ Brake)



GX-60-P  
(w/o Brake)

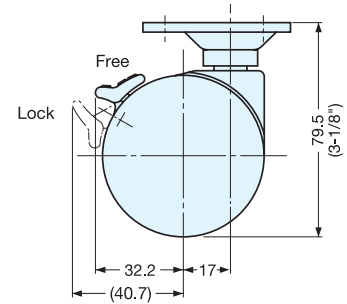
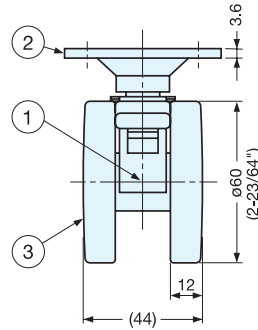
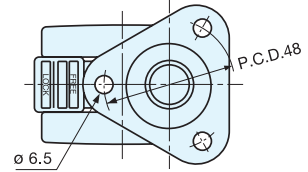

Item No.	Type	Load Capacity (kg)	Weight (g)	Box (pcs)	Carton (pcs)	No.	Part Name	Material	Finish
GX-60-PS	w/ Brake	150 ( 330 lbs )	234	4	60	①	Body	Aluminum Alloy	Polished
GX-60-P	w/o Brake	150 ( 330 lbs )	229			②	Mounting Plate	Steel	Yellow Zinc Chromate
						③	Wheel	Polyamide	Black

TWIN WHEEL CASTER (THREADED BOLT TYPE)



GX-60-N12S, N12

- Heavy duty and low profile.
- Twin wheel caster with excellent stability.



GX-60-N12S  
(w/ Brake)



GX-60-N12  
(w/o Brake)

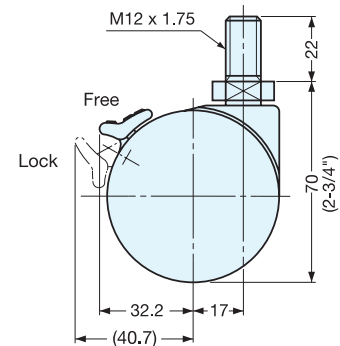
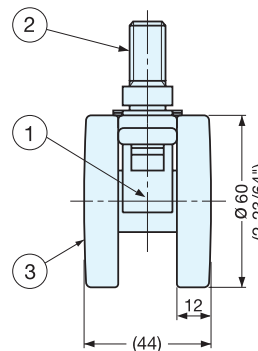
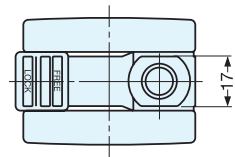

Item No.	Type	Load Capacity (kg)	Weight (g)	Box (pcs)	Carton (pcs)	No.	Part Name	Material	Finish
GX-60-N12S	w/ Brake	150 ( 330 lbs )	185	4	60	①	Body	Aluminum Alloy	Polished
GX-60-N12	w/o Brake	150 ( 330 lbs )	180			②	Threaded Bolt	Steel	Yellow Zinc Chromate
						③	Wheel	Polyamide	Black